



These diaphragm pressure switches are IP 55, and suitable for a variety of applications such as: chemical, petrochemical and conventional power station. They withstand the most unfavourable working conditions, caused by either the process fluid aggressiveness or high ambient temperature.

### 3.25 - Standard Model

**Ranges:** 0...40 mbar / 0...600 mbar.

**Electrical specifications:** N. 1 SPDT microswitches. (see microswitches table)

**Differential:** fixed.

**Ripeatability:**  $\leq 1\%$  of the full setting value.

**Set point adjustment:** internal, micrometric adjustable.

**Protection:** IP 55 as per EN 60529 / IEC 529

**Electrical wiring:** terminal screw, directly on microswitch.

**Earth contacts:** N. 1 internal, N. 1 external.

**Process temperature:** +212°F max (100°C).

**Ambient temperature:** -13...+149°F (-25...+65 °C).

**Thermal drift:**  $\leq 0,027\%$  / °F ( $\leq 0,05\%$  / °C).

**Process connection:** AISI 316L st.st.

**Elastic element:** AISI 316 Ti st.st. diaphragm.

**Gasket:** PTFE

**Case:** aluminium, blue polyurethane painted.

**Cover:** aluminium, beige polyurethane painted.

**Tag:** stainless steel, silk-screen painted.

**Weight:** 6.61 lbs (3 kg).

Setting range	Test pressure	Differential 1 micro (1)
5...40 mbar	0,5 bar	4 mbar
5...60 mbar	0,5 bar	4 mbar
5...100 mbar	0,5 bar	4 mbar
8...160 mbar	0,5 bar	6 mbar
8...250 mbar	1 bar	6 mbar
15...400 mbar	1 bar	10 mbar
15...600 mbar	1 bar	10 mbar

(1) differential and minimum set-point values for microswitches cod. I, N, S, U are 300% of those shown in table.

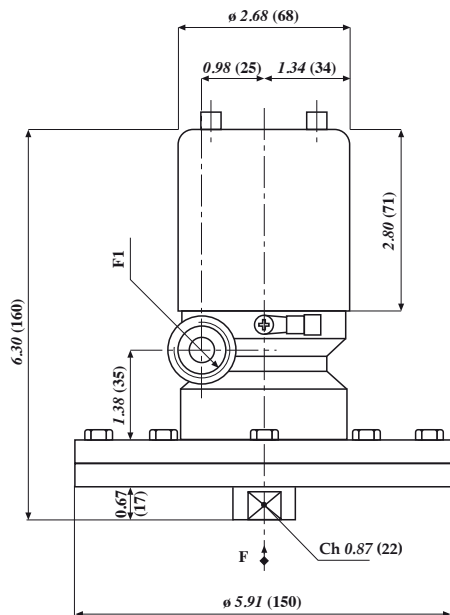

dimensions : inches (mm)

F1	
1	- R 1/2-ISO 7/1
3	- 1/2-14 NPT
P11	- cable gland

F	
43F	- R 1/2-18 NPT F
43M	- 1/2-14 NPT
41M	- G 1/2 B

Set-point adjustment

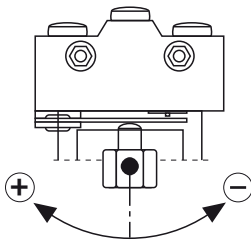

MICROSWITCHES  
ohmic load

Single	Type	250	125	24
		Vac	Vac	Vdc
C	std.	15A	15A	0,1A
G	SPLASH	15A	15A	0,1A
I	goldplated		1A	0,1A
M	inert gas filled	15A	15A	0,1A
N	goldplated and inert gas filled		1A	0,1A
S	SPLASH VDC	15A	15A	6A
U	inert gas filled VDC	15A	15A	6A

OPTIONS

P02 - Degreasing for oxygen
S16 - Wall mounting bracket
T01 - Tropicalisation
V20 - Epoxy painting

"HOW TO ORDER" SEQUENCE

Section / Model / Set-point Adjustment / Microswitch / Electrical connection / Process connection / Options					
3	25	C, G	1	41M	P02...V20
		I, M	3	43M	
		N, E	P11	43F	
		S, U			